



*Making  
Power  
Perform*

# PRODUCT CATALOGUE



[www.kedbrooke.com](http://www.kedbrooke.com)

Quality Management System

Certificate Nr. 20MS200701  
Issue Date: July 20, 2020



### Certificate of Registration

STAREGISTER certifies that, after successful auditing, the Management System of

**Kedbrooke General Trading LLC**

located at  
P.O Box 20196, Platinum Business Centre,  
8th Floor, Office No. 808, Al Quasis, Al Nahda - 2,  
Dubai United Arab Emirates

was found to comply to the requirements established in the standard :

**ISO 9001 : 2015**  
"Quality Management Systems-Requirements"

with the Scope:  
**Stocking Trading and Distribution of Electrical Products**  
IAF Sector Code : 29

Initial Certification : July 20, 2020  
Expiry Date : July 20, 2023  
1<sup>st</sup> surveillance :  
2<sup>nd</sup> surveillance :

*Yasmin Dmir*  
Certification Manager



www.staregister.org  
150 N. Michigan Ave  
Suite 2800  
Chicago, IL 60601

1001-7  
Use of this certificate is subject to terms of certification Agreement.  
This certificate remains the property of STAREGISTER International Inc.

Certificate Nr. 20MS060701  
Issue Date: July 06, 2020



### Certificate of Registration

STAREGISTER certifies that, after successful auditing, the Management System of

**Kedbrooke Middle East Fzco**

located at  
P.O Box 42831, Hamriyah Free Zone,  
Sharjah-United Arab Emirates

was found to comply to the requirements established in the standard :

**ISO 9001 : 2015**  
"Quality Management Systems-Requirements"

with the Scope:  
**Trading of Electrical Products**  
IAF Sector Code : 29

Initial Certification : July 06, 2020  
Expiry Date : July 06, 2023  
1<sup>st</sup> surveillance :  
2<sup>nd</sup> surveillance :

*Yasmin Dmir*  
Certification Manager



www.staregister.org  
150 N. Michigan Ave  
Suite 2800  
Chicago, IL 60601

F1001-7  
Use of this certificate is subject to terms of certification Agreement.  
This certificate remains the property of STAREGISTER International Inc.

Quality Management System



Established in 2005 Kedbrooke Electricals Ltd, UK (formerly known as Kedbrooke Industries Ltd) is an international leading manufacturer and distributor of electrical products under the brand name "KEDBROOKE".

KEL is reputed for the quality of its products, which have been certified by international laboratories and acknowledged by customers worldwide.

At KEL our vision is to provide our customers all over the world a basket of electrical products under a trustworthy global brand through an organization admired for its people, partnership, mission and performance.

KEL is dedicated to ensure supply of reliable, efficient and safe products at reasonable prices for the global market. Operating out of more than 20 contractual manufacturing facilities spreading over different countries, KEL exports its products to Middle East, Africa, Europe and South East Asia.

# INDEX

.....

Fans - Commercial & Industrial

05-12

Lamps & Lighting

13-22

G.I. Conduits & Accessories

23-26

Cable & Cable Accessories

27-34

Wiring Accessories

35-40

Enclosures & Junction Boxes

41-42

Water Heaters

43-44



*Making Power Perform*

[www.kedbrooke.com](http://www.kedbrooke.com)



# FANS - COMMERCIAL & INDUSTRIAL

CEILING FAN

WALL FAN

STAND FAN

ORBIT FAN

WINDOW MOUNTED EXHAUST FAN

AUTO SHUTTER FAN

ELECTRIC SHUTTER FAN

CEILING DUCT EXHAUST FAN

INDUSTRIAL PEDESTAL FAN

INDUSTRIAL WALL FAN

INDUSTRIAL MIST FAN

INDUSTRIAL EXHAUST FAN

PORTABLE BLOWER FAN

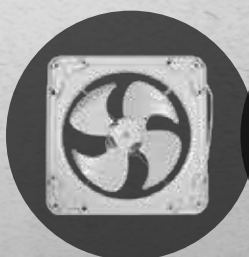

## CEILING FAN - KBQS 56

- ◆ Perfect design with nice appearance
- ◆ Powerful and durable motor with double ball bearing, producing strong air flow
- ◆ Controlled normal temperature during operation
- ◆ 5 speed wall mounted regulator with patent

### SPECIFICATIONS:

Voltage / Frequency	220-240V/50Hz
Motor Power	80W
Motor external diameter	238mm
Cover of motor	Plastic cover
Motor Weight.	3.2KGS with copper windings
Motor Speed	≥290 RPM
Bearings	Double bearings, 6202#
Down Rod	300mm
Motor Temperature	≤75 K
Color	Body - White, Ring - Silver or Gold
Rotor Diameter	∅ 152MM
Rotor Thickness	16.9mm



Stator Diameter	127.5 mm
Blade Thickness	Hot rod steel 0.8mm
Blade length	620 mm
Blade angle	5°
Canopy	PP
Regulator	ABS with 5 speed

## CEILING FAN - KBDS 56-10

- ◆ Perfect design with nice appearance
- ◆ Powerful and durable motor with double ball bearing, producing strong airflow
- ◆ Keeping normal temperature during operation
- ◆ 5-speed wall-mounted regulator with patent
- ◆ More colors option also

Voltage & Frequency	220-240V, 50HZ
Motor Power	75 W
Motor external diameter	196 mm
Cover of motor	hot-rolled steel
Motor Weight.	2.5 Kgs with copper windings
Motor Speed	≅ 290 RPM
Bearings	Double Bearings, 6202#
Down Rod	200mm
Motor Temperature	≤75 K
Rotor Diameter	152 mm



Rotor Thickness	14.95mm
Stator Diameter	127.5 mm
Blade material	Hot-rolled steel 0.78 mm
Blade length	625 mm
Blade angle	5°
Canopy	PP
Regulator	PP with 5 speed

# WALL FAN, STAND FAN & ORBIT FAN



## WALL FAN

- ◆ Double ball bearing motor for durable operation
- ◆ 5 star highest energy efficient fan
- ◆ 3 speed rotating control with rope.
- ◆ 3 AS Blades



## STAND FAN

- ◆ 5 star highest energy efficient fan
- ◆ 5-pp blades for powerful cooling
- ◆ 120-minute timer switch
- ◆ 3 speed control
- ◆ Adjustable height (118cm – 158cm)



## ORBIT FAN

- ◆ Metal blade for powerful cooling
- ◆ 5 star highest energy efficient fan
- ◆ 360 Degree oscillation
- ◆ 4 speed control





## WINDOW MOUNTED EXHAUST FAN - ROUND

- ◆ First class plastic PP material
- ◆ Silicon steel motor with built-in thermo-cut-off protection
- ◆ Advanced blade design for high air volume and low noise level
- ◆ Easy installation for glass and wall

### SPECIFICATIONS:

Model	Rated Voltage	Rated Frequency	Rated Power	Air Delivery	Noise
	[V]	[Hz]	[W]	[M3/h]	[dB]
<b>KBEF15G(6")</b>	220-240	50/60	15	260	37
<b>KBEF20G(8")</b>	220-240	50/60	20	320	40



## WINDOW MOUNTED EXHAUST FAN - SQUARE

- ◆ First class plastic PP material
- ◆ Silicon steel motor with built-in thermo-cut-off protection
- ◆ Advanced blade design for high air volume and low noise level
- ◆ Easy installation for glass and wall

### SPECIFICATIONS:

Model	Rated Voltage	Rated Frequency	Rated Power	Air Delivery	Noise
	[V]	[Hz]	[W]	[M3/h]	[dB]
KBE15A(6")	220-240	50/60	23	258	39
KBE20A(8")	220-240	50/60	28	480	44
KBE25A(10")	220-240	50/60	38	720	45
KBE30A(12")	220-240	50/60	48	1100	48



## AUTO SHUTTER FAN

- ◆ First class ABS material
- ◆ Silicon steel motor with built-in thermo-cut-off protection
- ◆ Big air flow and quite
- ◆ Easy installation for glass and wall
- ◆ Automatic thermo-actuator for shutter open/close

### SPECIFICATIONS:

Model	Voltage	Input (W)	Air-Flow (m³/h)	Noise (dB)	Size (mm)
KBAF15	220-240	22	220	37	150
KBAF23	220-240	40	520	40	230





# VENTILATING FAN

## ELECTRIC SHUTTER FAN

- ◆ First class ABS & PP material
- ◆ Silicon steel motor with built-in thermo-cut-off protection
- ◆ Big air flow and quite
- ◆ Easy installation for glass and wall

### SPECIFICATIONS:

Model	Size(Inch)	Watts	Voltage	Air Delivery	Speed	Current
KBE15E16"	6"	23W	220-240V	240m3/h	1300r/min	0.13A
KBE20E18"	8"	28W	50/60Hz - T45	360m3/h	1250r/min	0.15A



## CEILING DUCT EXHAUST FAN

- ◆ First class ABS material
- ◆ Silicon steel motor with built-in thermo-cut-off protection
- ◆ Advanced blade design for high air volume and low noise level
- ◆ Easy installation for glass and ceiling.

### SPECIFICATIONS:

Model	Size (Inch)	Rated Voltage	Rated Frequency	Rated Power	Air Delivery	Noise
		[V]	[Hz]	[W]	[M3/h]	[dB]
KBE10C	4"	220-240	50/60	13	58	40
KBE15C	6"	220-240	50/60	22	162	45



## CEILING DUCT EXHAUST FAN

- ◆ First class ABS material
- ◆ Silicon steel motor with built-in thermo-cut-off protection
- ◆ Advanced blade design for high air volume and low noise level
- ◆ Easy installation for glass and ceiling.

### SPECIFICATIONS:

Model	Size (Inch)	Rated Voltage	Rated Frequency	Rated Power	Air Delivery	Noise
		[V]	[Hz]	[W]	[M3/h]	[dB]
KBAPT20A	8"	220-240	50/60	23	258	47
KBAPT25A	10"	220-240	50/60	28	432	49



# PEDESTAL & WALL FAN - INDUSTRIAL

## PEDESTAL / STAND FAN - HEAVY DUTY

- ◆ Large air volume and low noise, effective motor
- ◆ Three speeds, chroming and dense guard
- ◆ Optimized alumized aluminum-iron blade structure, two or three blades
- ◆ Suitable for cooling-down temperature in mineral factories, workshops, warehouses and halls etc.

Model	Size	Sweep	Power	Voltage	Frequency	Speed	dB(A)	Airflow M <sup>3</sup> /min
KBPF24HD	24"	24" 60CM	230W	220-240V	50Hz	1350 RPM	76	185 M <sup>3</sup> /min
KBPF26HD	26"	26" 65CM	230W	220-240V	50Hz	1350 RPM	80	205 M <sup>3</sup> /min
KBPF30HD	30"	30" 75CM	280W	220-240V	50Hz	1350 RPM	86	290 M <sup>3</sup> /min

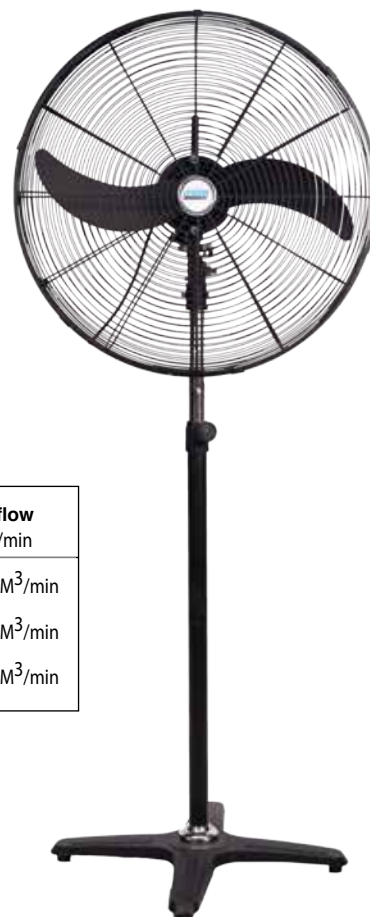

## WALL MOUNT - HEAVY DUTY

- ◆ Full cooling temperature system, motor with a long service life
- ◆ Novel outlook, large air volume, low temperature rise and noise
- ◆ Three speeds, powder, chroming and dense guard
- ◆ Optimized aluminum-iron blade structure, two or three blades
- ◆ Suitable for cooling-down temperature in mineral factories, workshops, warehouses and halls etc.

Model No.	Size	Sweep	Power	Voltage	Frequency	Speed	Current	Airflow M <sup>3</sup> /min
KBWF20HD	20"	20" 50 CM	130 W	220 - 240V	50Hz	1350 RPM	0.7 A	170 M <sup>3</sup> /min
KBWF24HD	24"	24" 60 CM	230 W	220 - 240V	50Hz	1350 RPM	0.7 A	185 M <sup>3</sup> /min



# MIST FAN - INDUSTRIAL

## CENTRIFUGAL / MIST FAN

Voltage : 220V-240V  
Frequency : 50Hz  
Size : 26"  
Power : 260W  
RPM : 1300 ~ 1400  
Tank : Plastic tank with 48L  
Max Mist volume : 5L/H  
100% Copper Motor with 3 speed

Suitable for Outdoor patios, sports activities, warehouses, garages, zoos, cookouts, pools, concerts, horse stables, outdoor wedding, greenhouses, receptions, amusement parks, special events, construction sites or any location that needs relief from the summer heat.

Model	Dia mm	Use Area (M2)	Temperature Drop(0C)	Air Volume (M3/min)	Noise	Measurement (H)	Oscillation Angle
KBFL650F-1	650	35	4-6	205	68	2200mm	0-900



## WALL MIST FAN

Model: KBFLW-650F-1  
Voltage: 220-240V  
Frequency: 50Hz  
Size: 26"  
Power: 260W  
Tank : Plastic tank with 14L  
RPM: 1300 ~ 1400  
Air Volume : 138

Suitable for warehouses, garages, receptions, special events, construction sites or any location that needs relief from the summer heat.



# VENTILATING FAN & BLOWER FAN - INDUSTRIAL

## EXHAUST FAN - INDUSTRIAL

- ◆ Epoxy powder coating to make it corrosion resistant against chemically charged atmosphere and saturated humid conditions
- ◆ Motors with class 'B' insulation to ensure operation at a high temperature
- ◆ Low noise rolling bearing, and it has a long service life
- ◆ High-quality, low weight, novel outlook, easy for install
- ◆ Suitable for ventilation in factory, residence, office, hotel and entertainment places etc



MODEL	FAN DIA (MM/INCH)	SPEED (RPM)	POWER WATTS	PHASE	CURRENT (AMP)	FREE AIR FLOW M3/HR	FT3/MIN
FA25B	250 (10")	1200	45	Single	0.21A	1100	640
FA30B	300(12")	1000	75	Single	0.34A	1800	1000
FA35B	350(14")	1200	135	Single	0.65A	2600	1500
FA40B	400(16")	950	160	Single	0.75A	4100	2400
FA45B	450(18")	900	250	Single	1.15A	5400	3100
FA50B	500(20")	850	350	Single	1.6A	6100	3500
FA60A	600(24")	950	200	Single	0.77A	8100	4700

## PORTABLE BLOWER - INDUSTRIAL

- ◆ Novel outlook, excellent craftwork, with U supporter
- ◆ Supporter and handle flexible using, movable operation with flexible duct
- ◆ Connecting a flexible soft duct, high pressure under long distance
- ◆ Suitable for underground, telecommunication, repairing tunnel project, warehouse etc.
- ◆ Available in 110V also.



Model	Size	Phase	Power V / W / Hz	Speed / Noise r.p.m / db (A)	Air-Flow (CBM/h)
KB-SHT20	200mm	1	220 / 230 / 50-60	2800-3300 / 63	25m <sup>3</sup> /min
KB-SHT25	250mm	1	220 / 320 / 50-60	2800-3300 / 68	43m <sup>3</sup> /min
KB-SHT30	300mm	1	220 / 520 / 50-60	2800-3300 / 71	65m <sup>3</sup> /min
KB-SHT35	350mm	1	220 / 750 / 50-60	2800-3300 / 76	82m <sup>3</sup> /min
KB-SHT40	400mm	1	220 / 1100 / 50	2800 / 80	96m <sup>3</sup> /min
KB-SHT45	450mm	1	220 / 1500 / 50	2800 / 83	162m <sup>3</sup> /min





# LAMPS & LIGHTING

LED SPOT LIGHT

LED LAMP

BATTEN FITTINGS WITH LED GLASS TUBE

LED WEATHERPROOF FITTINGS

LED PANEL LIGHT

LED DOWN LIGHT

LED CEILING LIGHT

LED STAND LIGHT

LED PANEL LIGHT

INSECT KILLER

LED FLOOD LIGHT

LED HIGH BAY

# LED SPOTLIGHT

Adjustable LED Spot light made of high quality plastic with aluminum reflector and PC cover, IP20.

Voltage : 170-240V  
 Life Span : 20,000 Hrs  
 Lumen : 90Lm/W  
 Adjustable : up to 45°  
 No flicker, Available in 7W and 10W,  
 Colour Temp.: 3000K, 4000K, 6500K



Model	Wattage	Lumen	Beam Angle	Colour Temp.	Cut Out	Dimension
KB-SPL7WW	7W	630	38°	3000K	70mm	ø90mm x H45mm
KB-SPL7DL	7W	630	38°	6500K	70mm	ø90mm x H45mm
KB-SPL10WW	10W	900	38°	3000K	100mm	ø120mm x H45mm
KB-SPL10DL	10W	900	38°	6500K	100mm	ø120mm x H45mm

## LED SPOTLIGHT - MR16 - GU 5.3 & GU 10

Voltage : 220-240V  
 CRI : ≥ 80  
 Beam Angle : 38°  
 Life Span : 15,000 Hrs  
 Lumen : 90Lm/W



Model	Wattage	Lumen Colour	Temp.
KB-GU5.3-7WW	7W	630	3000K
KB-GU5.3-7DL	7W	630	6500K
KB-GU10-7WW	7W	630	3000K
KB-GU10-7DL	7W	630	6500K

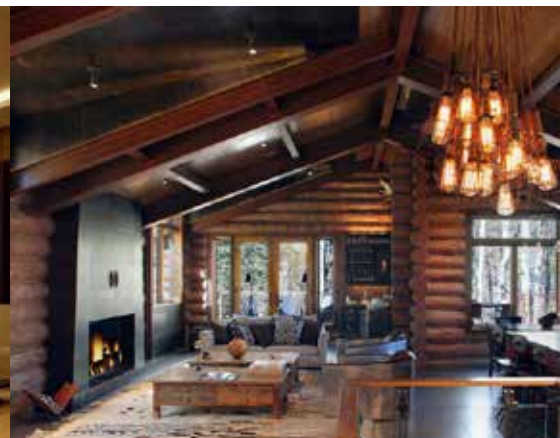

# LED LAMPS

## LED Filament Antique Lamp -ST64

Perfect alternatives to incandescent bulb.  
This filament bulb is built with an attractive vintage design,  
preserve the style of traditional Edison light bulbs.  
Suitable for application of art lamps.

Voltage : 170-240V 50/60Hz  
Colour Temp. : 3000K/4000K/6500K  
Beam Angle : 360°  
Colour : Clear  
Lamp Base : E27, E14  
Lumen : 100 Lm/W  
Life Span : 25,000 Hrs



Model	Wattage	Lumen	Colour Temp.	Base	PF	CRI
KB-ST64LED-8WW	8W	800	3000K	E27	0.9	100
KB-CLE14-4WW	4W	400	3000K	E14	0.9	100
KB-CLE14-4DL	4W	400	6500K	E14	0.9	100

## LED BULB - E27

with aluminum shell (Non Dimmable)

Voltage : 170-240V  
Power Factor : >0.5  
CRI : ≥ 80  
Beam Angle : 240°  
Operating Temp. : -20°C to 50°C  
Life Span : 15,000 Hrs



Model	Base	Wattage	Lumen	Colour Temp.
KB-LB-E27-9W	A60-E27	9W	810	6500K
KB-LB-E27-15W	A70-E27	15W	1350	6500K
KB-TB9D	E27	9W	900	6500K
KB-TB13D	E27	13W	1300	6500K

# BATTEN FITTINGS WITH LED GLASS TUBE

## LED GLASS TUBE

Watts : 13W & 25W  
 Voltage : 220-240V  
 Body : PC  
 Life Span : 15,000 Hrs



## BATTEN WITH LED GLASS TUBE - MAX

LED batten made of sheet steel body  
 Voltage : 220-240V, IP Rating : IP20  
 Life Span : 15,000 Hrs



Model	Wattage	Lumen	Colour Temp.	PF	CRI	Length
KBML-BF113	1x13W	1040lm	6500K	0.9	80	0.6m
KBML-BF125	1x25W	2250lm	6500K	0.9	80	1.2m

## BATTEN WITH LED GLASS TUBE - LUMINO

LED batten made of sheet steel body  
 Voltage : 220-240V  
 IP Rating : IP20  
 Life Span : 25,000 Hrs



Model	Wattage	Lumen	Colour Temp.	PF	CRI	Length
KB-LBF-12	1x12W	900	6500K	0.9	80	0.6m
KB-LBF-22	1x22W	2100	6500K	0.9	80	1.2m
KB-LBF-212	2x12W	1800	6500K	0.9	80	0.6m
KB-LBF-222	2x22W	4200	6500K	0.9	80	1.2m

## LED MIRROR LIGHT WITH SWITCH

Voltage : 220-240V  
 IP Rating : IP20  
 Life Span : 15,000 Hrs



Model	Wattage	Lumen	Colour Temp.	PF	CRI	Length
KB-ML112S	1x12W	900	6500K	0.9	80	0.6m



# LED WEATHERPROOF FITTINGS - IP65

## LED WEATHERPROOF FITTINGS WITH ABS + PC COVER + METAL CLIPS

Voltage : 220-240V  
Life Span : 15,000 Hrs



## WEATHERPROOF - ECO WITH METAL CLIPS

Model	Wattage	Lumen	Colour Temp.	PF	CRI	Length
KBLWP-12	1x13W	900	6500K	0.9	80	0.6m
KBLWP-14	1x25W	2100	6500K	0.9	80	1.2m
KBLWP-22	2x13W	1800	6500K	0.9	80	0.6m
KBLWP-24	2x25W	4200	6500K	0.9	80	1.2m

## WEATHERPROOF WITH METAL CLIPS

Voltage : 220-240V  
Life Span : 25,000 Hrs



Model	Wattage	Lumen	Colour Temp.	PF	CRI	Length
KB-WP12LED	1x13W	900	6500K	0.9	80	0.6m
KB-WP14LED	1x25W	2100	6500K	0.9	80	1.2m
KB-WP22LED	2x13W	1800	6500K	0.9	80	0.6m
KB-WP24LED	2x25W	4200	6500K	0.9	80	1.2m



# LED PANEL LIGHT & LED DOWN LIGHT

## LED PANEL LIGHT - RECESSED & SURFACE

LED Slim panel light made of die-cast aluminum body with PC diffuser.

- Size : 6", 8" & 10"
- Watts : 12W, 18W & 24W
- Voltage : 85V-265V 50Hz
- CRI :  $\geq 70$
- Lumen : 80 lm/W
- IP Rating : IP20
- LED Driver : Isolated
- Lifetime : 30,000 Hrs



## LED DOWNLIGHT - COB

LED COB downlight made of die-cast aluminum body with glass diffuser. IP 20.

- Voltage : 170-240V
- Life Span : 25,000 Hrs
- Lumen : 90Lm/W
- Power Factor :  $>0.9$



Model No.	Wattage	Lumen	Beam Angle	CRI	Colour Temp.	Dimension
KB-LCD20DL	20W	1800	38°	$\geq 70$	6500K	ø170mm x H60mm
KB-LCD30WW	30W	2700	38°	$\geq 70$	3000K	ø220mm x H60mm
KB-LCD30NW	30W	2700	38°	$\geq 70$	4000K	ø220mm x H60mm
KB-LCD30DL	30W	2700	38°	$\geq 70$	6500K	ø220mm x H60mm



# LED CEILING LIGHT & LED STAND LIGHT

## LED CEILING LIGHT

Made of non yellowing polycarbonate body,

Life Span : 15,000 Hrs

IP Rating: IP20



Model No.	Wattage	Lumen	Beam Angle	CRI	Colour Temp.
KBLCL18W	18W	1600 Lm	120°	>76	6500
KBLCL24W	24W	2000Lm	120°	>76	6500

## LED STAND LIGHT

Aluminum fitting with anodized aluminium reflector. LED Light source shield made of tempered glass, resistant to shock and temperature changes. Fitting equipped with Tripod. High IP rating (IP 65), protects the light source against dust and water penetration.



Voltage: 240V/50Hz, Material: Die Casting aluminum, IP Rating: IP65

Model No.	Wattage	Lumen	Colour Temp.	Body Colour
KBFLIC19003	1x50W	4250 Lm	6500K	Yellow
KBFLIC19003	2x50W	8500 Lm	6500K	Yellow

# LED PANEL LIGHT

## LED PANEL LIGHT - 60x60

Ultra thin design, 70% energy saving  
Luminous efficiency up to 90lm/W UGR<19  
Made of high quality aluminum frame.  
with PMMA diffuser (No yellowing), No flicker.

Life Span : 30,000 HRS  
Size : 595 x 595mm  
IP Rating : IP20



Model No.	Wattage	Lumen	Beam Angle	CRI	Colour Temp.
KB-SL-M45-40W WW	40W	3600 Lm	120°	>80	3000K
KB-SL-M45-40W NW	40W	3600 Lm	120°	>80	4000K
KB-SL-M45-40W DL	40W	3600 Lm	120°	>80	6500K





# LED PANEL LIGHT & INSECT KILLER

## LED PANEL LIGHT - 60x60

Ultra thin design, Made of high quality aluminum frame with PC diffuser.

Life Span : 15,000 HRS  
Size : 595 x 595 mm  
IP Rating : IP20



Model No.	Wattage	Lumen	Beam Angle	CRI	Colour Temp.
KB-SL-M45-36W DL	36W	2520 Lm	120°	>80	6500K
KB-SL-M45-48W DL	48W	3360 Lm	120°	>80	6500K
KB-SL-M45-60W DL	60W	4200 Lm	120°	>80	6500K

## INSECT KILLER

Available Sizes: 2x6W, 2x8W, 2x10W, 2x15W, 2x20W



Patented design

Best quality UV-A tube to ensure 100% Insect killing rate

International safety approved inner components for high quality assurance

Open-ended, but safely protective outer mesh for maximum attraction rate

With collection tray for easy cleaning

Made for hanging or free-standing

No chemical, eco-friendly

Ideal for using at kitchen, restaurant

# LED FLOOD LIGHT & LED HIGH BAY

## LED FLOOD LIGHT



High efficient LED flood light suitable for outdoor and indoor area lighting. Body made of die-cast aluminum, black powder coated with toughened glass. With high quality SMD chips. Save up 80% energy have better lighting characteristics than traditional metal halide.

*Features:*

- Slim & Compact design, Instant start, No flickering
- High strength and impact resistance
- Life span: 30,000 hrs
- IP 65
- Working temp: -40°C to 60°C

Model No.	Watts Efficiency	Voltage	Luminous	Color Temp	CRI	IP Rating	Power factor	Beam Angle (Hrs)	Lifetime Materials	Housing
KB-TG-D-30W	30W	85-265V	≥100LM/W	6500K	≥70	IP65	0.9	120°	30,000	Aluminum
KB-TG-D-50W	50W	85-265V	≥100LM/W	6500K	≥70	IP65	0.9	120°	30,000	Aluminum
KB-TG-D-100W	100W	85-265V	≥100LM/W	6500K	≥70	IP65	0.9	120°	30,000	Aluminum
KB-TG-D-150W	150W	85-265V	≥100LM/W	6500K	≥70	IP65	0.9	120°	30,000	Aluminum
KB-TG-D-200W	200W	85-265V	≥100LM/W	6500K	≥70	IP65	0.9	120°	30,000	Aluminum

## LED HIGH BAY



Attractive design, compact, Black powder coated, Heavy duty die-cast aluminum housing with cover made of poly carbonate. It has been treated to eliminate glare without affecting performance.

*Features:*

- Easy installation for suspended mounting
- Extremely high system efficiency, up to 140lm/w
- Available wide flood beam angles
- Long life time up to 50,000 Hrs
- Protection level is IP65
- Consumes 50% less energy than traditional metal halide highbay
- Compact design is great for installations with limited space
- 100W, 150W available

# G.I. CONDUIT & ACCESSORIES

G.I CONDUIT - CLASS 4

G.I CONDUIT - CLASS 3

CONDUIT FITTINGS & ACCESSORIES

GI FLEXIBLE CONDUITS

G.I JUNCTION BOX



# G.I. CONDUIT CLASS 4 & CLASS 3



## G I CONDUIT - CLASS 4

Hot Dip Galvanised Steel Conduits complying to BS 4568 Part 1 :1993.  
 Hot dip galvanised (Heavy Protection), both inside and outside.  
 Both ends threaded with one coupler and protected with plastic cap at the other end.  
 Standard Length is 3.75 meters (10pcs / bundle).



PART No.	Size (mm)	Outside Diameter		Wall Thickness (mm)	Length (meters)	Length of Thread		Primary Bundle (pcs)
		Min	Max			Min	Max	
<b>KBC420</b>	20	18.9mm	19.05mm	1.6±0.15	3.75	11.5mm	13.5mm	10
<b>KBC425</b>	25	25.25mm	25.4mm	1.6±0.15	3.75	13.0mm	15.0mm	10
<b>KBC432</b>	32	31.5mm	31.8mm	1.6±0.15	3.75	16.0mm	18.0mm	10

Also available in 40 & 50mm inside & outside galvanised class 4 (BS31)

## G I CONDUIT - CLASS 3

Pre Galvanised Steel Conduits complying to BS 4568 Part 1 :1993.  
 Pre Galvanised (Heavy Protection), both inside and outside.  
 Both ends threaded with one coupler and protected with plastic cap at the other end.  
 Standard Length is 3.75 meters (10pcs / bundle).



PART No.	Size (mm)	Outside Diameter		Wall Thickness (mm)	Length (meters)	Length of Thread		Primary Bundle (pcs)
		Min	Max			Min	Max	
KBC320	20	19.7mm	20.0mm	1.35±0.15	3.75	13.0mm	15.0mm	10
KBC325	25	24.6mm	25.0mm	1.35±0.15	3.75	16.0mm	18.0mm	10
KBC332	32	31.6mm	32.0mm	1.35±0.15	3.75	18.0mm	20.0mm	10



# CONDUIT FITTINGS & ACCESSORIES

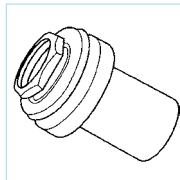

## Flanged Coupling No. KB 110/KB111

Material: Malleable Iron  
 Complete with washer and brass bush  
 Finishes: Black Enamel, Galvanised  
 P110(Lead washer)  
 P111(Neprence washer)  
 Size: 20mm 25mm 32mm

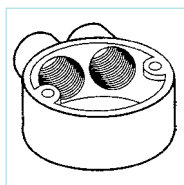

## Branch Two Way (U) No. KB 195

Size: 20mm 25mm  
 Pack Qty: 10 10

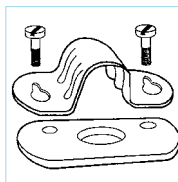

## Spacer Bar Saddle No. KB 431

Material: Steel  
 Finishes: Black Enamel, Galvanised  
 Size: 20mm 25mm 32mm

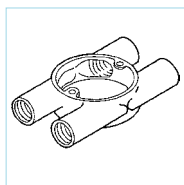

## Twin Through Way (H) No. KB 197

Size: 20mm 25mm  
 Pack Qty: 10 10

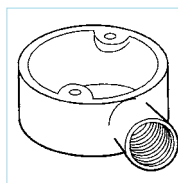

## Terminal (1 way) No. KB 181

Size: 20mm 25mm  
 Pack Qty: 10 10

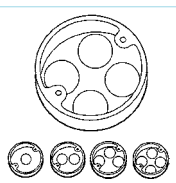

## Malleable Iron Medium No. KB 272

Material: Malleable Iron. Finishes: Black Enamel, Galvanised. With tapped hole in base for earthing screw. 1,2,3,4Holes.  
 Minimum: 31mm Deep X 63.5mm Inter.Dia.

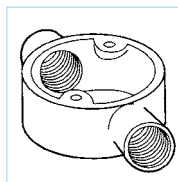

## Through (2 way) No. KB 182

Size: 20mm 25mm  
 Pack Qty: 10 10

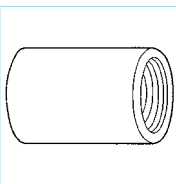

## GI Coupler No. KB 101

Material: Steel  
 Finishes: Black Enamel, Galvanised  
 Size: 20mm 25mm 32mm  
 Size: 1½" 2"

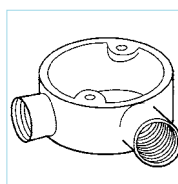

## Angle (A way) No. KB 183

Size: 20mm 25mm  
 Pack Qty: 10 10

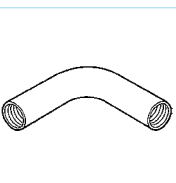

## Internal Thread Normal Bends No. KB 141

Material: Steel  
 Finishes: Black Enamel, Galvanised  
 Size: 20mm 25mm 32mm

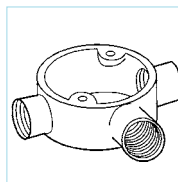

## Tee (3 way) No. KB 184

Size: 20mm 25mm  
 Pack Qty: 10 10

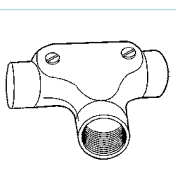

## Channel Inspection Tee No. KB 133

Material: Malleable Iron,  
 Finishes: Black Enamel, Galvanised  
 Size: 20mm 25mm 32mm

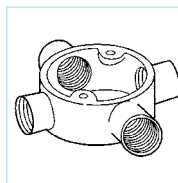

## Intersection (4 way) No. KB 185

Size: 20mm 25mm  
 Pack Qty: 10 10



# G.I FLEXIBLE CONDUIT & G.I JUNCTION BOX

## G.I FLEXIBLE CONDUIT WITH PVC COATED

Kedbrooke GI Flexible Conduit with PVC coating is intended to protect cables in applications where there is repeated flexing, vibration and bending. When installing wiring systems, adherence to the current wiring regulations is strongly advised.

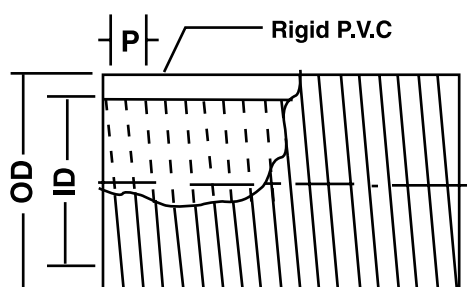

CODE No.	Outer Dia	Inner Dia	Thickness Of Steel Strip (Width*thickness)
KFC-20	20MM	16.5MM	8.6*0.22MM
KFC-25	25MM	21.0MM	9.5*0.22MM
KFC-32	32MM	27.5MM	12.7*0.25MM
KFC-40	43MM	38.0MM	12.7*0.28MM
KFC-50	52MM	46.0MM	17*0.35MM

## G.I JUNCTION BOX



MODEL	SIZE	THICKNESS	DEPTH	KNOCK OUT HOLE SIZE	EARTHING
KGIB3X3	3 X 3	0.8MM	35MM	20MM & 25MM	BRASS TERMINAL
KGIB3X3BS	3 X 3	1.1MM	35MM	20MM & 25MM	BRASS TERMINAL
KGIB3X6	3 X 6	0.8MM	35MM	20MM & 25MM	BRASS TERMINAL
KGIB3X6BS	3 X 6	1.1MM	35MM	20MM & 25MM	BRASS TERMINAL

All Kedbrooke GI Junction boxes with adjustable lug.

# CABLE & CABLE ACCESSORIES

RUBBER CABLE

CAT 6 CABLE

CABLE GLANDS

CABLE LUGS

EARTHROD & ACCESSORIES

BRASS ADAPTOR

CABLE PULLER

BENDING SPRING

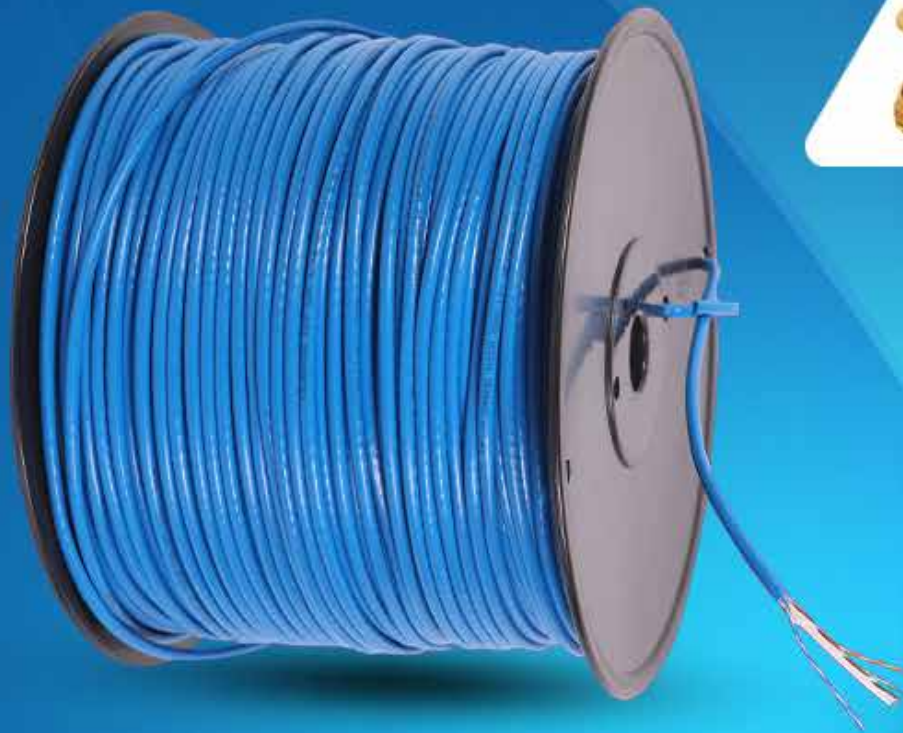

# RUBBER CABLE - H07RN-F

LOW VOLTAGE 450/750 V



## Reliability and Flexibility.

Based on : EN-50525-2-21

### DESIGN

#### Conductor

Electrolytic copper, class 5 or 6 (flexible), based on EN 60228

#### Insulation

Thermosetting rubber (type EI4).

The standard identification is the following:

- 1X..... Natural
- 2X..... Brown Blue
- 3G..... Brown Blue Yellow/green
- 4G..... Brown Black Grey Yellow/green
- 5G..... Brown Black Grey Blue Yellow/green
- 6G.or more ---- Black numbered Yellow/Green



#### Outer sheath

Thermosetting rubber (type EM2). Black colour.

### APPLICATIONS

H07RN-F is a rubber flexible power cable specifically designed to operate in tough weather conditions and under high mechanical and thermal stresses. The hard-wearing H07RN-F cable is made up of class 5 flexible plain copper conductors, EPR (Ethylene Propylene Rubber) insulation and a black CPE sheath. With its oil, grease and water resistant sheath, H07RN-F cable is suitable for use in a whole range of different applications, including handling equipment, mobile power supplies and stage and audio equipment.

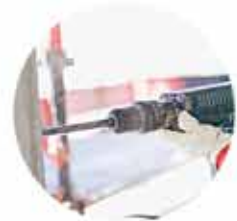

### CHARACTERISTICS



Flexible Conductor  
Class 5/6



Outdoor Installation



Max Service  
Temperature: 90°C



Abrasion  
Resistance



Flame Non-propagation



Meter by Meter  
Marking



Anti-twist Resistant



Max Short-circuit  
Temperature:  
250°C (Max. 5 s)



Min Bending Radius  
5 - 6 Cable Diameter



Min Service  
Temperature:  
-40°C(Fixed)



Heavy Mobile Use



Industrial Use



Chemical & Oil  
Resistance



Robotics

### INSTALLATION CONDITIONS



# CAT-6 CABLE

LAN CABLE | 305M / Roll  
 Category 6, UTP Cable 4 pair, Blue

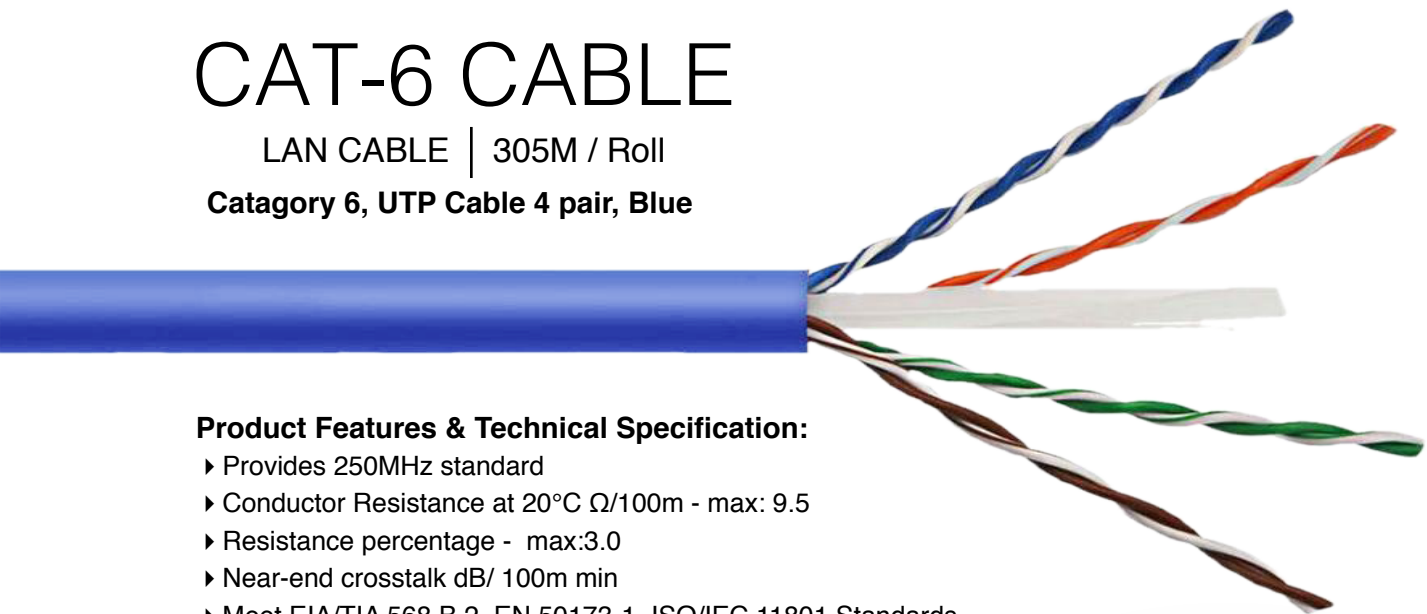

### Product Features & Technical Specification:

- ▶ Provides 250MHz standard
- ▶ Conductor Resistance at 20°C Ω/100m - max: 9.5
- ▶ Resistance percentage - max:3.0
- ▶ Near-end crosstalk dB/ 100m min
- ▶ Meet EIA/TIA 568 B.2, EN 50173-1, ISO/IEC 11801 Standards.
- ▶ PVC jacket with HDPE insulation.
- ▶ Solid wire 24(AWG) Bare copper conductor
- ▶ Operating temperature: -20°C to +75°C
- ▶ Return Loss (Min. at 250MHz): 17.3 dB
- ▶ Attenuation: (Min. at 250 MHz) : 30.5 dB

### Benefits

- ▶ Improved signal strength ▶ Better speed & performance
- ▶ Supports Gigabit ethernet

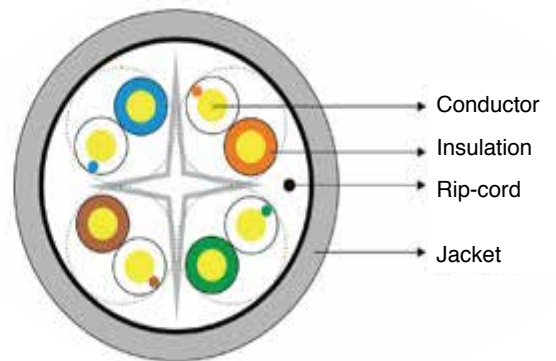

TRANSMISSION SPECIFICATIONS							
Frequency (MHz)	Attenuation(Max) (dB/100m)	NEXT(Min) (dB/100m)	PSNEXT (Min) (dB/100m)	ELFEXT (Min) (dB/100m)	PS ELFEXT(db)	RL(Min) (dB)	Delay(ns)
1	2	86.1	81.1	82.1	75.3	20	100±15
4	3.5	82.7	77	73.6	65.1	23	100±15
10	5.5	71.9	67.8	63.7	55.3	25	100±15
16	7.6	66.6	63.1	60.6	54.1	25	100±15
20	8.9	66	62.3	58.2	47.8	25	100±15
31.25	10.1	64.9	59.1	54	46	23.6	100±15
62.5	14.5	60.3	55.2	44	41.2	21.5	100±15
100	18.7	59.5	51.9	42.5	37.5	20.1	100±15
200	27.2	57.2	45.6	35.6	30.7	18	100±15
250	30.5	55.2	43.6	30.3	22.2	17.3	100±15



# CABLE GLANDS

## BW BRASS CABLE GLANDS

- To BS 6121: Part 1.
- Suitable for single wire armoured, plastic or rubber sheathed cables.
- Application - for use in dry, indoor situations.
- Low cost two part design.
- Shroud may be used for additional ingress protection.
- IP 54.
- Finish : Natural Brass and also available in Electro Tinned and Nickel.
- Threads: Entry threads are metric to BS 3643 and are also available in Imperial (ET).
- Also available in Aluminium (BS 1474) cable glands.

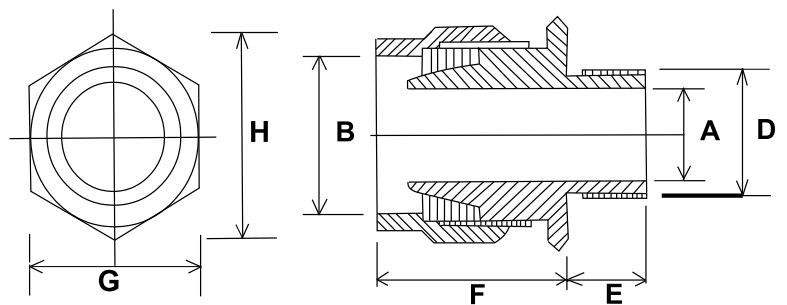

STANDARD : B.S. 6121, Part-1 : 1989

APPLICATION : Indoor, for use with all type of SWA Cables

FUNCTION : Provides for Armour Clamp Only

MECHANICAL : Provides retention of Armour or Brand Impact Resistant

GLAND SIZE	ENTRY THREAD		CABLE ACCEPTANCE DETAIL			ACROSS FLAT	ACROSS CORNER
	DIA. C	LENGTH MINIMUM E	DIA. MAX. A	DIA. MAX. B	ARMOUR DIA. D		
20 S	20	10	12.00	16.00	0.9/1.25	21.00	23.40
20 L	20	10	15.00	20.00	0.9/1.25	24.00	26.80
25 L	25	10	20.00	26.00	1.25/1.60	31.70	35.00
32 L	32	10	26.30	32.50	1.60/2.00	39.80	45.00
40 L	40	12	32.30	40.00	1.60/2.00	49.50	56.00
50 L	50	13	44.00	53.20	2.00/2.50	60.50	68.50
63 L	63	13	55.00	66.00	2.50	76.00	85.80
75 L	75	16	67.00	78.00	2.50	89.50	100.00
90 L	90	18	79.00	90.00	2.50/3.15	104.30	117.00

# CABLE GLANDS

## CW BRASS GLANDS FOR SWA CABLE

- To BS 6121: Part 1.
- Suitable for single wire armoured, plastic or rubber sheathed cables.
- Outer seal grips sheath of cable.
- For use in most climatic conditions weatherproof and waterproof.
- Seal rated to IP 66.
- Design has separate armour locking ring.
- Gland rated to IP 66 with use of suitable sealing washer or thread sealant at gland interface.
- Finish : Natural Brass and also available in Electro Tinned and Nickel.



## CW FLAME PROOF GLAND FOR SWA CABLE

as above but with these additional benefits:

- For use in hazardous environments
- Complies with BS 5501 Pt1 & Pt 6
- CW for flame proof increased safety application
- Threads: Entry threads are metric to BS 3643 and are also available in Imperial(ET)
- Also available in Aluminium (BS 1474) cable glands

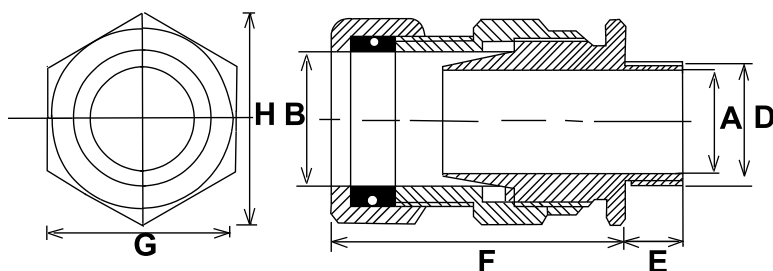

GLAND SIZE	ENTRY THREAD		CABLE ACCEPTANCE DETAIL			ACROSS FLAT	ACROSS CORNER
	DIA. C	LENGTH MINIMUM E	DIA. MAX. A	DIA. MAX. B	ARMOUR DIA. D		
20 S	20	9	11.60	16.00	0.9/1.25	21.50	24.50
20 L	20	9	14.00	20.00	0.9/1.25	24.20	27.30
25 S	25	9	19.00	24.00	1.25/1.60	30.00	33.60
25 L	25	10	20.00	27.00	1.25/1.60	30.00	34.40
32 S	32	10	24.00	30.50	1.60/2.00	36.50	40.00
32 L	32	10	26.20	33.00	1.60/2.00	36.50	42.30
40 S	40	11	30.00	37.00	1.60/2.00	44.50	50.00
40 L	40	11	32.50	41.00	1.60/2.00	46.50	52.00
50 S	50	13	40.00	47.50	2.00/2.50	55.00	62.00
50 L	50	13	44.00	52.60	2.00/2.50	59.00	66.00
63 S	63	14	51.00	60.00	2.50	69.00	76.00
63 L	63	14	55.00	66.00	2.50	73.00	82.00
75 S	75	15	62.00	72.00	2.50	83.00	94.00
75 L	75	15	67.00	78.00	2.50	86.30	98.00
90 L	90	19	79.00	90.00	2.50/3.15	105.00	118.00

# CABLE GLANDS

## E1W GLAND FOR SWA CABLE

- Suitable for single wire armoured, plastic or rubber sheathed, extruded bedded cables
- Outer seal grips sheath of cable
- Inner seal grips bedding layer of cable
- For use in most climatic conditions weatherproof and waterproof
- Inner and outer seal rated to IP 66
- Design has separate armour locking ring
- Gland rated to IP66 with use of suitable washer or thread sealant at gland interface
- Finish : Natural Brass and also available in Electro Tinned and Nickel

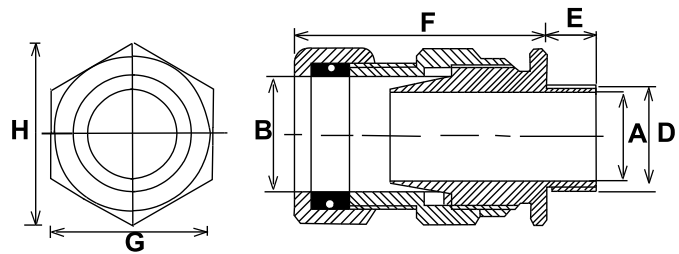

## E1W FLAME PROOF GLAND FOR SWA CABLE

- For use in hazardous environments
- Complies with BS5501 Pt1 & Pt 6
- E 1 W increased safety application
- Threads: Entry threads are metric to BS3643 and are also available in Imperial (ET)
- Also available in Aluminium (BS 1474) cable glands

## A1 A2 CABLE GLANDS



### CABLE GLAND KIT CONTAINS :

Gland  
Lock Nut  
Shroud  
Earth Tag

Kit contains two sets of above items up to 32mm sizes & one set from 40mm and above sizes

A1 A2 Type brass indoor cable gland is used with all types of unarmoured cable, providing mechanical cable retention. sealing is provided on the cable outer sheath.

A1 A2 range of industrial cable gland is designed and tested as per BS 6121:Part 1:1989. It meets the requirements of EN 50262 : 1999.

### TECHNICAL INFORMATION

<b>Type</b>	: A2
<b>Design Specification</b>	: BS 6121: Part 1: 1989.
<b>Ingress Protection Rating</b>	: IP66
<b>Standard Gland Material</b>	: Brass
<b>Optional Gland Material</b>	: Nickel Plated Brass
<b>Cable Type</b>	: Unarmoured
<b>Sealing Area(s)</b>	: Cable Outer Sheath
<b>Available Accessories</b>	: Steel/Brass Locknut, PVC/LSF Shroud Brass Earth Tag, Nylon Washer, Brass Reducer

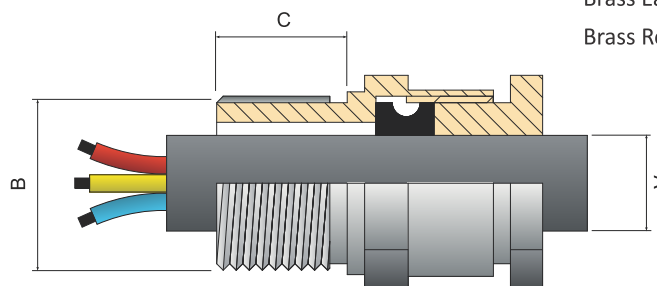

# HEAVY DUTY CABLE LUGS

## TUBULAR CABLE LUGS

FOR COPPER CONDUCTORS

Heavy Duty

Material : E-Copper-BS 1977

Surface : Tin Plated

(With or Without inspection hole)

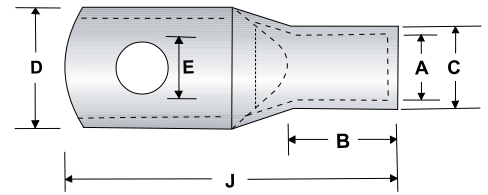

Cable mm <sup>2</sup>	STUD Ø E	ID A	OD C	Palm Width D	Barrel Length B	LEN J	CODE
1.5	4.2	1.8	3.7	8.0	5	16	KB 1.5-4
	5.2	1.8	3.7	8.0	5	16	KB 1.5-5
	6.5	1.8	3.7	10.0	5	18	KB 1.5-6
2.5	4.2	2.4	4.0	8.0	7	18	KB 2.5-4
	5.2	2.4	4.0	10.0	7	20	KB 2.5-5
	6.5	2.4	4.0	10.0	7	20	KB 2.5-6
	8.4	2.4	4.0	9.0	7	24	KB 2.5-8
4	4.2	3.1	4.8	10.0	7	20.0	KB 4.-4
	5.2	3.1	4.8	10.0	7	20.0	KB 4.-5
	6.5	3.1	4.8	10.0	7	20.0	KB 4.-6
	8.2	3.1	4.8	12.0	7	24.0	KB 4.-8
6	5.2	3.8	5.5	10.0	9	23.0	KB 6-5
	6.5	3.8	5.5	10.0	9	23.0	KB 6-6
	8.4	3.8	5.5	12.0	9	27.0	KB 6-8
	10.5	3.8	5.5	15.0	9	32.0	KB 6-10
10	6.5	4.5	6.2	12.0	9	25.0	KB 10-6
	8.4	4.5	6.2	12.0	9	27.0	KB 10-8
	10.5	4.5	6.2	15.0	9	32.0	KB 10-10
16	6.5	5.4	7.1	12.0	12	30.0	KB 16-6
	8.4	5.4	7.1	12.0	12	30.0	KB 16-8
	10.5	5.4	7.1	15.0	12	36.0	KB 16-10
	13.0	5.4	7.1	18.0	12	38.0	KB 16-12
25	6.5	6.8	8.8	13.0	12	30.0	KB 25-6
	8.4	6.8	8.8	16.0	12	30.0	KB 25-8
	10.5	6.8	8.8	18.0	12	37.0	KB 25-10
	13.0	6.8	8.8	18.0	12	37.0	KB 25-12
35	6.5	8.2	10.6	15.3	12	35.0	KB 35-6
	8.4	8.2	10.6	15.3	12	35.0	KB 35-8
	10.5	8.2	10.6	18.0	12	38.0	KB 35-10
	13.0	8.2	10.6	20.0	15	43.0	KB 35-12
	17.0	8.2	10.6	20.0	15	43.0	KB 35-16
50	8.4	9.2	11.2	15.5	16	43.0	KB 50-8
	10.5	9.2	11.2	15.5	16	43.0	KB 50-10
	13.0	9.2	11.2	15.5	16	43.0	KB 50-12
	17.0	9.2	11.2	15.5	16	47.0	KB 50-16
70	8.4	11.5	14.0	20.5	18	50.0	KB 70-8
	10.5	11.5	14.0	20.5	18	50.0	KB 70-10
	13.0	11.5	14.0	20.5	18	50.0	KB 70-12
	14.7	11.5	14.0	20.5	18	57.0	KB 70-14
95	10.5	12.9	15.6	23.0	20	55.0	KB 95-10
	13.0	12.9	15.6	23.0	20	55.0	KB 95-12
	14.7	12.9	15.6	23.0	20	55.0	KB 95-14

Cable mm <sup>2</sup>	STUD Ø E	ID A	OD C	Palm Width D	Barrel Length B	LEN J	CODE
120	10.5	14.6	18.0	26.0	22	60.0	KB 120-10
	13.0	14.6	18.0	26.0	22	60.0	KB 120-12
	14.7	14.6	18.0	26.0	22	64.0	KB 120-14
	17.0	14.6	18.0	26.0	22	64.0	KB 120-16
150	10.5	16.0	19.5	28.0	26	69.0	KB 150-10
	13.0	16.0	19.5	28.0	26	69.0	KB 150-12
	14.7	16.0	19.5	28.0	26	69.0	KB 150-14
	17.0	16.0	19.5	28.0	26	69.0	KB 150-16
	21.0	16.0	19.5	28.0	26	79.0	KB 150-20
185	10.5	18.7	22.4	33.0	44	78.0	KB 185-10
	13.0	18.7	22.4	33.0	44	78.0	KB 185-12
	14.7	18.7	22.4	33.0	44	78.0	KB 185-14
	17.0	18.7	22.4	33.0	44	78.0	KB 185-16
	21.0	18.7	22.4	33.0	44	78.0	KB 185-20
240	10.5	21.9	25.9	38.0	38	92.0	KB 240-10
	13.0	21.9	25.9	38.0	38	92.0	KB 240-12
	14.7	21.9	25.9	38.0	38	92.0	KB 240-14
	17.0	21.9	25.9	38.0	38	92.0	KB 240-16
	21.0	21.9	25.9	38.0	38	92.0	KB 240-20
	BL	21.9	25.9	38.0	38	92.0	KB 240-BL
300	13.0	23.4	28.0	41.0	42	101.0	KB 300-12
	14.7	23.4	28.0	41.0	42	101.0	KB 300-14
	17.0	23.4	28.0	41.0	42	101.0	KB 300-16
	21.0	23.4	28.0	41.0	42	101.0	KB 300-20
	BL	23.4	28.0	41.0	42	101.0	KB 300-BL
400	13.0	28.6	34.0	48.0	44	114.0	KB 400-12
	14.7	28.6	34.0	48.0	44	114.0	KB 400-14
	17.0	28.6	34.0	48.0	44	114.0	KB 400-16
	21.0	28.6	34.0	48.0	44	114.0	KB 400-20
	BL	28.6	34.0	48.0	44	114.0	KB 400-BL
500	17.0	31.0	36.0	54.0	48	124.0	KB 500-16
	21.0	31.0	36.0	54.0	48	124.0	KB 500-20
	BL	31.0	36.0	54.0	48	124.0	KB 500-BL
630	13.0	35.0	41.0	62.0	56	144.0	KB 630-12LD
	35	45.0				144	KB 630-BL
	39	50.6				170	KB 800-BL
	43	56.2				200	KB 1000-BL
	17.0	35.0	41.0	62.0	56	144.0	KB 630-16LD
	21.0	35.0	41.0	62.0	56	144.0	KB 630-20LD
630	17.0	35.0	45.0	65.0	56	144.0	KB 630-16 HD
	21.0	35.0	45.0	65.0	56	144.0	KB 630-20 HD
	BL	35.0	45.0	65.0	56	144.0	KB 630-BL HD
800	BL	39.0	50.6	73.5	78	170	KB 800-BL HD
1000	BL	43	56.2	81.0	90	200	KB 1000-BL HD



# EARTHROD & ACCESSORIES, BRASS ADAPTOR, CABLE PULLER & BENDING SPRING



## BONDED COPPER EARTH RODS

**KED BROOKE** Bonded Copper Earth Rods are made from high tensile strength steel (Copper Plated).

## SOLID COPPER EARTH ROD & ACCESSORIES

**KED BROOKE** Solid Copper Earth Rods are made from pure EC Copper (Natural Finish).

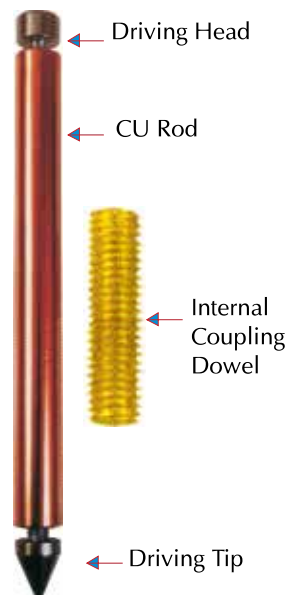

Earth rod Coupler & Clamp  
16 & 20mm



Adaptor - Brass / Nickel plated  
20 & 25mm

## CABLE PULLER & BENDING SPRING

### CABLE PULLER



### IRON CABLE PULLER WITH 2 RING PULLS & 2.5 MM THICKNESS

KCP10	Length 10meter
KCP20	Length 20meter
KCP30	Length 30meter

### BENDING SPRING



### BENDING SPRING FOR PVC CONDUIT

KPBS20	Length 500mm	20mm Dia.
KPBS25	Length 500mm	25mm Dia.
KPBS32	Length 500mm	32mm Dia.

# WIRING ACCESSORIES

BS SWITCHES & SOCKETS

METAL CLAD SWITCHES & SOCKETS

WEATHER PROOF SWITCHES

WEATHERPROOF ISOLATOR

INDUSTRIAL PLUG & SOCKET

TERMINAL BLOCKS

CABLE REELS

UNIVERSAL MULTI PIN ADAPTOR

EXTENSION SOCKETS

PLUG TOP

PG GLANDS & CEILING ROSE

PVC TRUNKING



# BS SWITCHES & SOCKETS

## WHITE PVC SWITCHES & SOCKETS - KBV

The comprehensive range includes all ranges such as: White PVC Switches and Sockets.



13A Double switch socket



45A DP Switch with neon



250W Fan controller

## METAL CLAD SWITCHES & SOCKETS - KBMC

Metal clad switches and sockets are perfect for factories, workshops, garages and sheds where they are needed to be that bit tougher than ordinary ones. As they are made from steel, they are tough and impact resistant.



13A Double switch socket



20A DP Switch with neon



3 Gang 2way switch

## WEATHERPROOF SWITCHES & SOCKETS - KBCL

Weatherproof switches and sockets are a great addition to outdoor space as they allow power outside whilst being protected against the elements.



13A WP double switch socket



2 Gang 2way WP switch



3 Gang 2way WP switch

# ISOLATOR, PLUG & SOCKETS, TERMINAL BLOCKS

## WEATHERPROOF ISOLATOR

Fixed Neutral & Earth bars included  
Dual 25 mm screwed entries top & bottom  
25 mm to 20 mm screwed reducers included  
2x25mm rear knockouts  
Padlockable for security  
Large terminals accommodate 25mm<sup>2</sup>



35A 2p WP Isolator IP65

## INDUSTRIAL PLUG & SOCKETS

Kedbrooke Industrial Plug & Socket series are in compliance with International Standards

Current : 16Amp/32Amp  
Voltage : 110V/220V/380V  
Protection Degree: IP44  
Ranges: Mobile Plug, Mobile Socket,  
Wall Mount Socket, Panel Mount



16A 3way multi socket



110V 32A 3pin socket



16A 3pin wall socket

## TERMINAL BLOCKS

Nickel plated brass terminal  
Captive screws of zinc-plated steel  
Engineering Plastic Casting  
Self-extinguishing material in compliance  
with IEC 60695-02 Standard 850C

Sizes:  
6 Sq.mm  
10 Sq.mm  
16 Sq.mm  
25 Sq.mm



20A 10mm strip connector



# CABLE REELS

**ESMA  
Approved**

## CABLE REEL - OPEN DRUM

KB2200-4-25 MTRS, KB2250-4-40 MTRS, KB2250-4-50 MTRS

- 250V open drum extension reels fitted with a 13Amp 3 pin plug and 4 outlet sockets.
- 1.5mm diameter 3 core heavy duty cable.
- Strong and durable for industrial use.
- Ideal for use with power tools, transformers etc.
- Unbreakable plastic body.
- Available in 25 Mtr, 40Mtr & 50 Mtr.



## CASSETTE REEL



KB-S2208-4-5 MTRS, KB-S2206-4-10 Mtr

- Portable power cassette reel provides power where you need it most
- Each unit has 4x13Amp socket outlets, 250V, PVC coated 1.25 sqmm insulated cable 3 core
- Available in 10Mtr & 5Mtr

## HANDBAG REEL

KB2225-4-25MTR

- 25Mtr 13Amp extension reel handbag style.
- Robust, easy wind action with integral hand grip and four socket outlets.
- Unbreakable plastic case with easy wind handle fitted with approved plugs.



# MULTI PIN ADAPTOR, EXTENSION SOCKET & PLUG TOP

## UNIVERSAL MULTI PIN ADAPTOR

Multipurpose use, can connect many plugs at one time  
Non flammable  
Vertical and horizontal design and the sockets are universal design  
so any country pin can go inside.



UNIVERSAL TRAVEL ADAPTOR with USB PORT:  
Universal Travel adaptor with USB PORT (AU/UK/US/EU)  
Surge protection  
Safety shutter  
Made in Malaysia

## UNIVERSAL EXTENSION SOCKET

Portable Extension socket outlets with individual neon switch  
13Amp 240V with different cable lengths - 2Mtr/3Mtr/5Mtr  
Fire retardant body of PC material  
Available in 2G, 3G, 4G, 5G & 6G



## PLUG TOPS

High impact poly carbonate (PC) body  
Fire retardant (FR) body  
Fitted with UK certified fuse, Approved by ASTA (BS1362)  
Product safety comply to BS 1362, SS145 & MS 589  
Available in 13A, 15A, 250V  
Made in Malaysia



# PG GLAND, CEILING ROSE & PVC TRUNKING

## PG GLANDS

Kedbrooke PG Glands can be used to fix cables and provide effective protection against dust and water from entering electrical distribution board, electro-mechanical controlling board and other instruments.



## CEILING ROSE

Kedbrooke Ceiling Rose provides electrical connection in one click action makes it very easy and convenient for lighting installations. All contacts are mounting & overall dimensions inaccessible and earth contact comes at first while clicking ensures safety standards.

Model: KBV6701  
Rating : 6A



## PVC TRUNKING

PVC trunking are used in Cable Management Systems to hide or protect the cable across the room, a floor or the wall.

Available in Sticker type & Normal (Non adhesive)

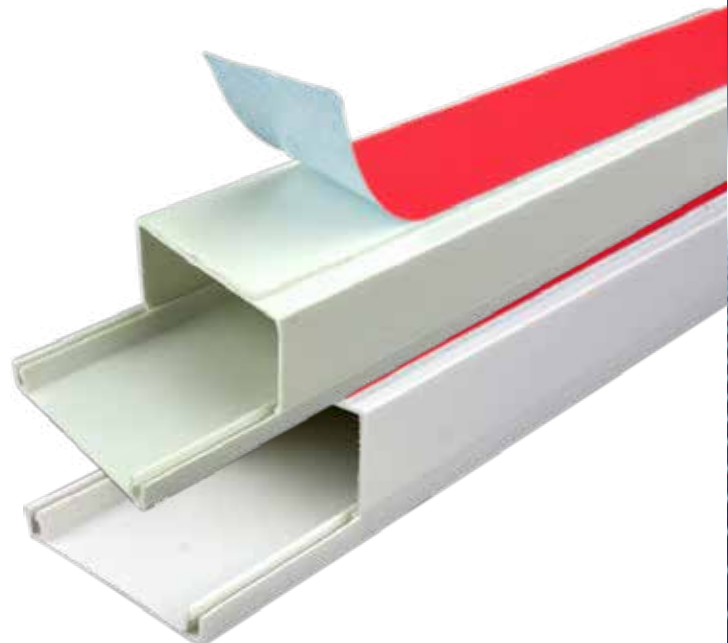

# ENCLOSURES & JUNCTION BOXES

METAL ENCLOSURES

PLASTIC JUNCTION BOX

ALUMINIUM JUNCTION BOX





# ENCLOSURES AND JUNCTION BOXES

## METAL ENCLOSURE

These enclosures are widely used in assemble of control box, terminal boxes, power distribution and instrument container with stainless steel latch, hinges and special locking device. Components include Door, Mounting Plate, Lock system, Gland Plate, Sealing gasket and fixing accessories.

Made of high quality sheet steel of thickness 1.2mm.

Epoxy polyester powder coating in RAL 7032.

Standard mounting plate of zinc coated steel of thickness 1.5mm.

Degree of protection upto IP66.



## PLASTIC JUNCTION BOX

High Intensity ABS, PC polyester assured flammability material.

Convenient for easy installation.

Cover with stainless steel screws, RAL 7035 grey.

Temperature range: -40°C to 120°C.

Degree of protection upto IP56.



## ALUMINIUM JUNCTION BOX

LV Aluminium boxes are suitable for installation, circuit breaking, connection and control of electric and electronic equipments, and find their main application in industrial, automotive, railways, navy, tunnels, parkings, industrial buildings fields ensuring a high mechanical and vibration resistance with IP66 protection degree.

It is a range of die cast aluminium junction boxes.

The cover is equipped with stainless steel captive screws.

Temperature Range: -50 to 130, Epoxy polyester powder coating in RAL7038.

Degree of protection upto IP66.



# WATER HEATERS

GALVANIZED IRON WATER HEATER & GLASS LINED WATER HEATER



# WATER HEATERS

## GALVANIZED IRON WATER HEATER

Made in Sultanate of Oman



- Single Weld Galvanized Iron Inner Tank
- High Quality Heating Element
- High Quality Automatic Thermostat
- Pressure Relief Valve For Extra Safety
- CFC Free Insulation Foam Saves Electricity
- Epoxy Polyester Powder Coated outer body

Rated Voltage	220 (V) - 240 (V)
Rated Input Power	1200 (W) / 1500 (W)
Power Frequency	50 HZ / 1PH
Set temperature maximum	75°C
Rated pressure	7 bar (MPa 0.7)
Inlet/Outlet pipe size	1/2" BSPT
Foam Insulation	20mm
Carton Thickness	5 Ply



Model No	Water Capacity	Diameter	Height	Carton Size (mm)	Gross Weight (Kgs)
KBGI 010V	10 Liters	290	340	340X 340 X 375	7.000
KBGI15V	15 Liters	290	440	340 X 340 X 465	8.500
KBGI30V	30 Liters	400	465	425 X 425X550	12.300
KBGI30H	30 Liters	400	465	425 X 425X550	12.500
KBGI50V	50 Liters	400	635	425 X 425 X 675	14.500
KBGI50H	50 Liters	400	635	425 X 425 X 675	14.700
KBGI80V	80 Liters	450	770	475 X 475 X 820	22.300
KBGI80H	80 Liters	450	770	475 X 475 X 820	22.700

## GLASS LINED WATER HEATER

Made in Sultanate of Oman

- High quality Glass lined (Enameled) steel inner tank
- Flange type Italian make heating element
- Double safety Italian automatic thermostat
- Pressure relief valve for extra safety
- Magnesium anode for protection of inner boiler
- Stainless steel inlet /outlet pipe
- CFC free insulation foam saves electricity
- Epoxy polyester powder coated outer body

Rated Voltage	220 (V) - 240 (V)
Rated Input Power	1200 (W) / 1500 (W)
Power Frequency	50 HZ / 1PH
Set temperature maximum	75°C
Rated pressure	7 bar (MPa 0.7)
Inlet/Outlet pipe size	1/2" BSPT
Foam Insulation	20mm
Carton Thickness	5 Ply



Model No	Water Capacity	Diameter	Height	Carton Size (mm)	Gross Weight (Kgs)
KBGL10V	10 Liters	290	340	340X 340 X 375	7.600
KBGL15V	15 Liters	290	440	340 X 340 X 465	8.500
KBGL30V	30 Liters	400	465	425 X 425X550	15.200
KBGL30H	30 Liters	400	465	425 X 425X550	15.300
KBGL50V	50 Liters	400	635	425 X 425 X 675	17.680
KBGL50H	50 Liters	400	635	425 X 425 X 675	18.000
KBGL80V	80 Liters	450	770	475 X 475 X 820	24.280
KBGL80H	80 Liters	450	770	475 X 475 X 820	24.500

# PRODUCT RANGE

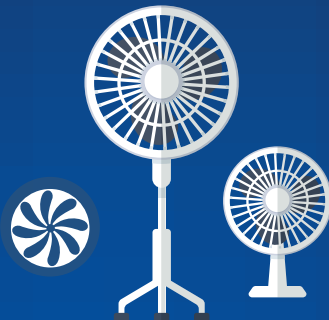

## FANS

- Ceiling Fan • Wall Fan • Stand Fan • Orbit Fan • Window Mounted Exhaust Fan • Auto Shutter Fan • Electric Shutter Fan • Ceiling Duct Exhaust Fan • Industrial Pedestal Fan • Industrial Wall Fan • Industrial Mist Fan • Industrial Exhaust Fan • Portable Blower Fan



## LAMPS & LIGHTING

- LED Spot Light • LED Lamp • Batten Fittings with LED Glass Tube • LED Weatherproof Fittings • LED Panel Light • LED Down Light • LED Ceiling Light • LED Stand Light • LED Panel Light • Insect Killer • LED Flood Light • LED High Bay

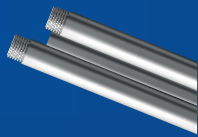

## G.I. CONDUIT & ACCESSORIES

- G.I Conduit - Class 4 • G.I Conduit - Class 3 • Conduit Fittings & Accessories • G.I Flexible Conduits • G.I Junction Box



## CABLE & CABLE ACCESSORIES

- Rubber Cable • Cat 6 Cable • Cable Glands • Cable Lugs • Earthrod & Accessories • Brass Adaptor • Cable Puller • Bending Spring



## WIRING ACCESSORIES

- BS Switches & Sockets • Metal Clad Switches & Sockets • Weather Proof Switches • Weatherproof Isolator • Industrial Plug & Socket • Terminal Blocks • Cable Reels • Universal Multi Pin Adaptor • Extension Sockets • Plug Top • PG Glands • Ceiling Rose • PVC Trunking

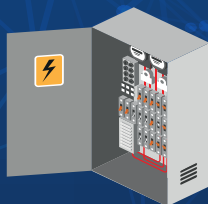

## ENCLOSURES & PVC BOXES

- Metal Enclosures • Plastic Junction Box • Aluminium Junction Box



## WATER HEATER

- Galvanized Iron Water Heater • Glass Lined Water Heater





**KEDBROOKE ELECTRICALS LTD**

Suite A, Bank House, 81 Judes Road, Egham  
TW20 0DF, United Kingdom  
E-mail: [info@kedbrooke.com](mailto:info@kedbrooke.com)

**KEDBROOKE MIDDLE EAST FZC**

P.O.Box. 42831, Hamriyah Free Zone  
Sharjah, United Arab Emirates  
Tel: +971 6 7489394, Fax: +971 6 7487975  
E-mail: [info@kedbrooke.com](mailto:info@kedbrooke.com), [exports@kedbrooke.com](mailto:exports@kedbrooke.com)

---

**KEDBROOKE GENERAL TRADING LLC**

P.O.Box: 20196, Dubai, United Arab Emirates  
Tel: +971 4 2288600, Fax: +971 4 2632025  
E-mail: [sales@kedbrooke.com](mailto:sales@kedbrooke.com)



[www.kedbrooke.com](http://www.kedbrooke.com)